

Sophia Cassam

From: David Williams
Sent: Tuesday, August 16, 2022 5:09 PM
To: Sophia Cassam; Comp Plan Update
Subject: FW: MRLO Request Egg Lake
Attachments: Egg Lake Quarry Public Records.pdf; Egg Lake Quarry Form SM-8A.pdf; Surface Mine Reclamation Permit Form SM-9.pdf

FYI, related to land use map requests.

From: Francine Shaw <fshaw@rockisland.com>
Sent: Tuesday, August 16, 2022 3:24 PM
To: David Williams <davidw@sanjuanco.com>
Cc: 'Myron Williams' <williamsent@hotmail.com>
Subject: RE: MRLO Request Egg Lake

CAUTION: This email originated from outside of the organization. Do not click links or open attachments unless you recognize the sender and know the content is safe.

Good afternoon, David:

Egg Lake Quarry is a known extractable resource with commercial quantities. It has been in operation for over 50 years, mining shale, since at least the early 1970's. (See attached public records for the 1986 permit issued for the expansion of the quarry.) Mining of this property continues today and will likely continue for another 40 years. (See attached WA Department of Natural Resources Form SM-8A.)

The purpose of the MRLO is to bring this mine into conformance with the San Juan County Code. It was established before land use districts (zones) and development regulations for mining uses existed in San Juan County. Mining on this site is considered a legal non-conforming use because the property is now zoned Rural Farm Forest which prohibits mining. The MRLO will recognize the mine as a conforming use.

The WA Department of Natural Resources (DNR) approved a Reclamation Plan for the quarry in 2016 (see attached Form SM-9 - Permit #70-013228). DNR recognizes that the mine has commercial quantities of extractable resources. I've also attached an Irrevocable Line of Credit granted to DNR that is used as a financial guarantee that the mine will be reclaimed once mining activity ceases to occur on the property.

I am unable to provide you with an economic report in this short notice but would be able to have one prepared before the re-designation application is brought before the County Council for final consideration if that acceptable.

Best regards,
Francine Shaw
Planning and Permit Services, LLC
P.O. Box 868
Friday Harbor, WA 98250-0868
(360) 298-4449

From: David Williams [<mailto:davidw@sanjuanco.com>]
Sent: Friday, August 12, 2022 2:38 PM
To: Francine Shaw
Subject: MRLO Request Egg Lake

Francine, per my voicemail, we need a report per the highlighted section below. Please let me know when you have a few minutes to chat. I think it can be fairly easily addressed in documents I am betting they already have.

Dave

18.35.015

A. Designation Procedures. A mineral resource land overlay district may be applied based upon the following criteria, only upon acceptance by the County of a complete application from a property owner and upon approval of a redesignation in accordance with SJCC [18.90.030](#). Mineral resource lands of long-term commercial significance are those lands from which the commercial extraction of minerals (sand, gravel, rock, and other valuable aggregate or metallic substances) can be anticipated within 20 years and which are characterized by all of the following:

1. Have a known or potential extractable resource in commercial quantities verified by submittal of a geologic and economic report prepared by a qualified professional;
2. Current or future land use will not exceed a residential density of one dwelling unit per 10 acres;
3. Are not within an activity center, rural residential, natural or conservancy designation or any shoreline designation;
4. Are not within a regulated wetland or fish and wildlife conservation area pursuant to SJCC [18.35.085](#) through [18.35.140](#).

David Williams
Community Development Director
San Juan County, Washington
www.sanjuanco.com
360-370-7571





Virus-free www.avast.com

10-EXP-86 Russell Cole Storage Bldg

San Juan Russell Cole
1793B Cattle, Pt. Rd.
Friday Harbor, WA 98250
378-5878

Project Address;
Project Description: Addition of 2500'
shop & storage bldg.
Project Location: 363242001

Designation: Comp Plan
Shoreline

Submitted: 10-27-86

Approved 11/17/86

Box #2

PLEASE



Planning Department
San Juan County

P.O. Box 947 • Friday Harbor, Washington 98250
206/378-2354 • 206/376-4851 • 206/468-3325

STAFF REPORT

REPORT DATE: November 5, 1986

TO: Colonel Sorenson, Planning Director

FROM: Pat Powell, Planner *MPW*

RE: Request for expansion of existing use (#10-EXP-86)

APPLICANT: Russell Cole
1793B Cattle Point Road
Friday Harbor, WA 98250

SUBMITTED: October 27, 1986

PROPOSAL: Construct a 2500 sq. ft. shop and storage building in association with shale operation.

COMP PLAN
DESIGNATION: Rural 2

LOCATION: Tax lot #363242001, located west of Egg Lake Road and Egg Lake (Attachments 1 and 2)

PROPOSAL:

The applicant proposes to construct a 46' x 52' structure to house a backhoe and dump truck which are used in conjunction with the shale pit operation on the site. The structure will also be used as a storage area for the owner's tools. The structure will have a height of less than 20' and will be finished with board and batt siding. Please refer to Attachments 3, 4, and 5 for building plans.

SITE CHARACTERISTICS:

The proposed structure will be placed on the front portion of a 32.45-acre tax lot. There are no other structures on this lot. The entire lot is heavily forested with the exception of the shale pit and its immediate surroundings. The shop will be located in close proximity to the shale pit but will be shielded from all adjacent properties by evergreen trees and distance.

sr/Cole

P001577-031517-000003

SEPA:

The proposed structure is exempt from SEPA as the total building area contains less than 4000 square feet (WAC 197-11-800).

APPLICABLE COMPREHENSIVE PLAN PROVISIONS:

- 16.44.020(D) Existing Uses
- 16.44.050(C) Rural Designation
- 16.44.120 Mineral Extraction

ANALYSIS:

Section 16.44.020(D), Existing Uses, states that this facility is allowed if it is not a change in use established prior to Comprehensive Plan adoption and there will not be significant impacts on adjacent properties.

FINDINGS AND CONCLUSIONS:

1. The shale pit use was established in the early 1970's, prior to adoption of the Comprehensive Plan on October 2, 1979.
2. The shale pit use has not been abandoned for a year or more since October 2, 1979. The continuation of use has been verified by the previous owner, Jim Wilson.
3. The proposed intensification (adding a shop) is limited to the contiguous property owned on October 2, 1979, by the then-owners of the area upon which the shale pit use is occurring.
4. The proposed shop structure is not expected to have a significant adverse impact on adjoining properties or the immediate neighborhood because it will be an extremely low-intensity, low-impact type of use, is visually buffered from the county road and adjacent properties by existing dense vegetation, and the design and exterior materials will fit into the rural character of the area.
5. To assure consistency with the Comprehensive Plan, conditions should be attached regarding limiting potential commercial use of the shop.

RECOMMENDATION:

Based upon the above-stated findings and conclusions, approval of the proposed intensification is recommended subject to the following conditions:

1. The approved building and site plans (Attachments 3, 4, and 5) shall be adhered to.

2. A sufficient vegetative buffer between the shop structure and surrounding properties and Egg Lake Road shall be maintained so that the structure is not visible from these locations.
3. Commercial use of the proposed structure shall be limited to the shale pit use.

ACTION:

Based on the findings and conclusions specified above, it is hereby determined that, as proposed, the subject request meets the requirement of Section 16.44.020 of the San Juan County Comprehensive Land Use Plan and, therefore, a conditional use permit is not required. The proposed expansion is therefore approved subject to the three listed conditions.

Any person aggrieved by the determination of the Administrator may request review by the Board of Adjustment. Any such request must be made in writing to the Administrator within 20 days of the following date.

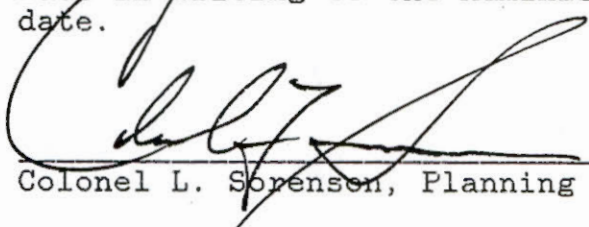

Colonel L. Sorenson, Planning Director

11 / 17 / 86

Date

Notice of this decision has been provided to the Building Department.

ATTACHMENTS:

1. Aerial photograph
2. Site Plan
3. South and west shop elevations
4. Foundation Plan
5. Structural Plan

RECEIPT

Date Oct 27 19 86

2279

Received From RUSSELL COLB

Address _____

~~THREE HUNDRED & SEVENTY-FIVE~~ Dollars \$ 375⁰⁰

For 2.04 DETERMINATION
LOG TIME

ACCOUNT			HOW PAID		
AMT. OF ACCOUNT			CASH		
AMT. PAID			CHECK	<u>243</u>	
BALANCE DUE			MONEY ORDER		

By [Signature]

8K808 REDIFORM

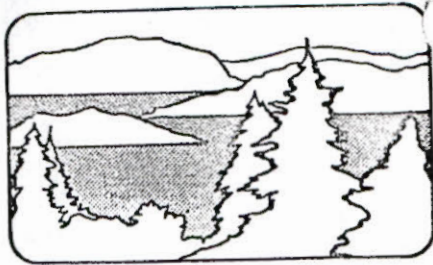

San Juan County Planning Department

P.O. Box 947 • Friday Harbor, Washington 98250 • 206/378-2354

FEE: \$375.00

REQUEST FOR DETERMINATION: Expansion, alteration, or intensification of an existing use. (Note: An "existing use" is a use that was in existence prior to the adoption of the Comprehensive Plan, regardless of whether the use conforms to Comprehensive Plan Regulations.)

PLEASE COMPLETE THE FOLLOWING:

1. DATE 10-24-86
 2. TAX LOT NO. OF LAND ON WHICH THE EXISTING USE IS LOCATED 363242001
 3. NAME OF OWNER RUSSELL COLL
ADDRESS 1793 B CATTLE PK RD - FRIDAY HARBOR WA
PHONE 378-5878
 4. HAS ALL THE LAND BEEN IN THE SAME OWNERSHIP SINCE OCTOBER 2, 1979?
() YES (X) NO IF "NO," EXPLAIN:
ENTIRE TRACT WAS SOLD IN OCT. 1986
 5. DESCRIBE THE EXISTING USE: SHADE PIT
 6. WHEN WAS THIS USE ESTABLISHED? _____
DAY MONTH YEAR 1974 OR EARLIER
 7. DESCRIBE ANY PREVIOUS CHANGES OR EXPANSIONS OF USE. PROVIDE DATES
None
 8. DESCRIBE THE PROPOSED CHANGES ADDITION OF 2 2500 #
SHOP & STORAGE BLDG.
- (attach site plan or other information if necessary)

9. WILL CHANGES NECESSITATE ACQUISITION OF ADDITIONAL LAND? () YES (X) NO
IF "YES," EXPLAIN _____
10. EXPLAIN ANY IMPACTS THE PROPOSED CHANGES MAY HAVE ON NEIGHBORING PROPERTY AND RESIDENTS, AND ON THE SURROUNDING AREA.

11. OWNER'S STATEMENT:
I represent that the statements submitted herewith are true and correct.

Russell Coll 10-27-86
signature of owner Date

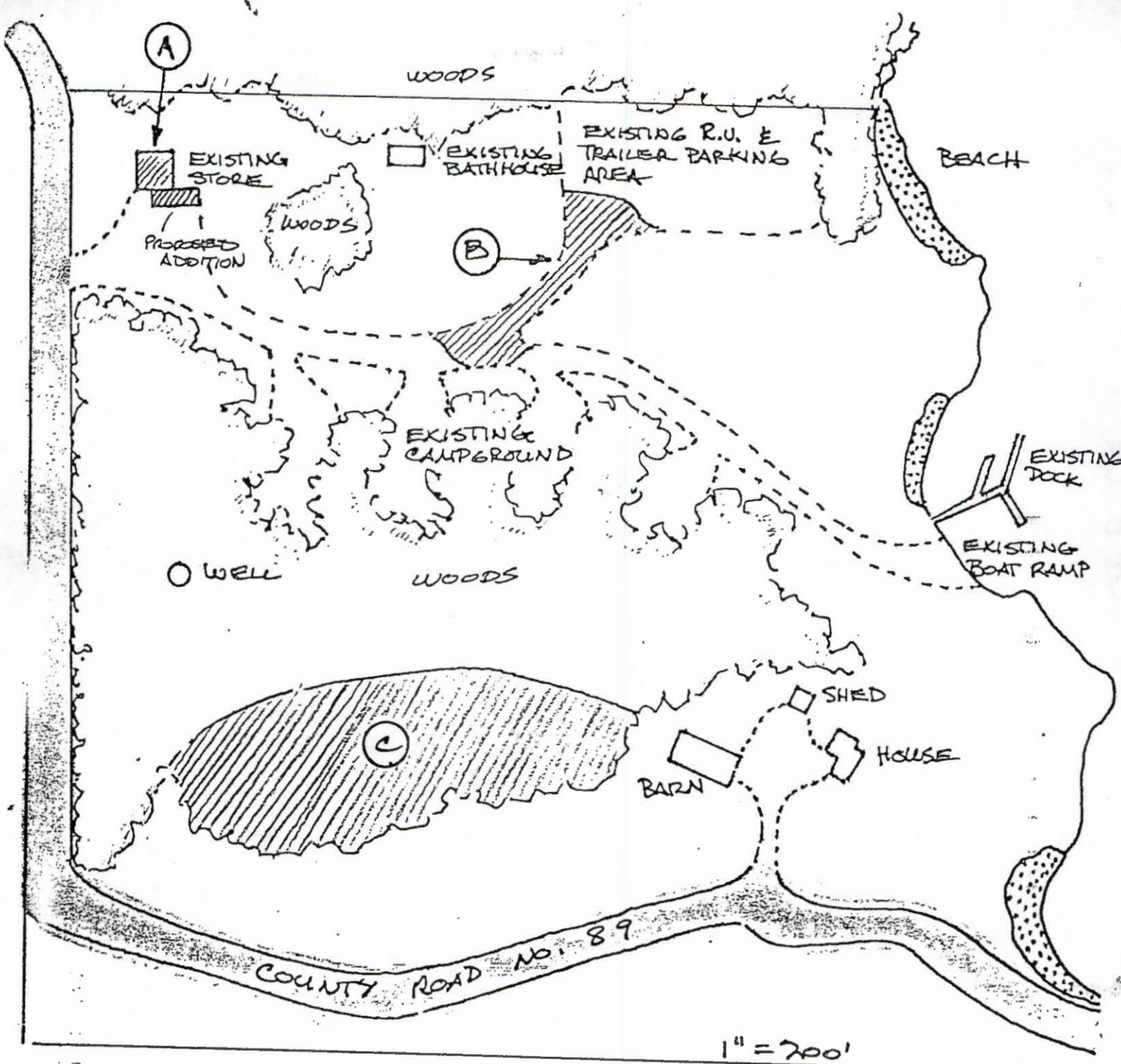

DRAWING OF PROPOSED CHANGES

PARCEL NO. 350411001

- (A) NEW SIGN ON STORE (4' x 8'), NEW OPEN FRUIT & VEGETABLE ADDITION
- (B) 120 YDS. FILL TO IMPROVE ROAD & LEVEL PARKING LOT
- (C) REMOVE 2 AC. TREES & PLANT VINYARD (CONSERVANCY AREA)

(SAMPLE SITE PLAN)
SCALE 1" = 200'

10/27/86 Site Inspection

Muell w/ Russell
Cote

Building will have gable roof w/ two side sheds and glass side lights, board & Batt siding. Shop will be used for work on & storage of 1 Backhoe & Pump truck used w/ shale pit and tool storage.

All fire trees will be left between ^{building} site and Egg Lake Road.

11/4/86

Spoke to ^(previous owner) Jim Wilson (378-4353) who began shale pit in early 1970's, much prior to Oct 1979 Camp Plan date. He stated the pit has been used every year since then altho' at times quantities taken out vary. The AER photos appear to VERIFY THIS.

FILE CLOSEOUT CHECKLIST

It's time to close out this file and I need to make sure all time has been recorded before billing. Please look over the time log sheet to see if the following are included, then return to me.

- File Startup
- Marshall's Time
- SEPA Determination *W/a*
- Site Inspection
- Staff Report
- Typing/Mailing *- 30*
- Colonel's Review
- Miscellaneous Telephone
- Bookkeeping *- 15*
- Other

27/CLOSELST

PLANNING DEPARTMENT
REQUEST TO TREASURER
TO REFUND APPLICATION FEES
AS PER RESOLUTION NO. 105-1985

DATE: 1/7/87

TO: Connie Erickson, Treasurer

RE: Russel Cole ~~10-EXP-86~~
Name of Applicant Permit No.

1793B Cattle Pt. Rd. 10/27/86
Street Address Application Date

Friday Harbor, WA 98250 2279
City, State, Zip P/C Receipt No.

25957 \$375.00
Treasurer's Receipt No. Amt of Receipt

Processing of the above "time logged" application is complete. It has been determined that 3.5 hours were spent in processing at \$35.00 per hour, for a total of \$ 122.50. This leaves a balance of \$ 252.50 to be refunded.

Please send the refund amount to the above named applicant.

APPROVED: 
Planning Director

1/19/87
Date

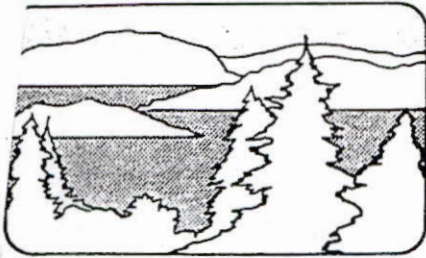

San Juan County
Planning Department

P.O. Box 947 • Friday Harbor, Washington 98250 • 206/378-2354

TO: ROAD DEPARTMENT

DATE: 10/24/86

RE: BUILDING PERMIT APPLICATION FOR COLE

TAX PARCEL NO. 363242001

When you have assigned a permit number for the access application associated with this building permit, please provide the permit number, your signature, and the date on the attached copy.

Please respond no later than NOV 3, 1986

Building Dept. will assume no objection if response is not received by the above date.

Thanks

Marshall Sanborn



**APPLICATION FOR
RECLAMATION PERMIT
(Form SM-8A)**

Check appropriate box(es): new permit revision of existing permit transfer of permit expansion

NOTE: Do not attempt to complete this form until you have carefully read "Instructions for Form SM-8A".

1. NAME OF APPLICANT/PERMIT HOLDER(S) Egg Lake Quarry LLC C/O Myron Williams				
2. MAILING ADDRESS 65 Gill Lane, Friday Harbor, WA 98250-9614				
3. Telephone (360) 378-2288 UBI No. 602-152-803				
4. NAME OF MINE Egg Lake Quarry				
5. Street address and milepost of surface mine The mine is located at 65 Gill Lane (0.6 milepost on Egg Lake Road).				
6. Distance (miles)	7. Direction from Northeast	8. Nearest community Friday Harbor		
9. COUNTY San Juan No attachments will be accepted. Legal Description of permit area:				
1/4	1/4	Section	Township	Range
	SE	32	36N	3W
10. TOTAL ACREAGE OF PERMIT AREA APPLIED FOR: (Include all acreage to be permitted. See Form SM-6.) <u>10.10</u> acres				
11. Do you or any person, partnership, or corporation associated with you now hold, or have you held, a surface mining operating or reclamation permit? <input type="checkbox"/> yes <input checked="" type="checkbox"/> no If you answered yes to the above, please list:				
Permit Number	Active Operation?		Reclamation current/complete?	
	Yes	No	Yes	No
	<input type="checkbox"/>	<input type="checkbox"/>	<input type="checkbox"/>	<input type="checkbox"/>
	<input type="checkbox"/>	<input type="checkbox"/>	<input type="checkbox"/>	<input type="checkbox"/>
	<input type="checkbox"/>	<input type="checkbox"/>	<input type="checkbox"/>	<input type="checkbox"/>
	<input type="checkbox"/>	<input type="checkbox"/>	<input type="checkbox"/>	<input type="checkbox"/>
12. Are all of these mines now in compliance with RCW 78.44, WAC 332-18, and conditions of the permits? <input type="checkbox"/> yes <input type="checkbox"/> no				
13. Have you ever had a surface mine operating or reclamation permit revoked? <input type="checkbox"/> yes <input checked="" type="checkbox"/> no Have you ever had a reclamation security forfeited? <input type="checkbox"/> yes <input checked="" type="checkbox"/> no If you answered yes to either of the above, give permit number(s):				
14. Type of proposed or existing mine: <input type="checkbox"/> pit <input checked="" type="checkbox"/> quarry Material(s) to be mined: <input type="checkbox"/> sand and gravel <input checked="" type="checkbox"/> rock or stone <input type="checkbox"/> clay <input type="checkbox"/> metal <input type="checkbox"/> limestone <input type="checkbox"/> silica <input type="checkbox"/> other Deposit type: <input checked="" type="checkbox"/> glacial <input type="checkbox"/> river floodplain (alluvial) <input type="checkbox"/> river channel deposits <input type="checkbox"/> talus <input checked="" type="checkbox"/> bedrock <input type="checkbox"/> lode <input type="checkbox"/> unknown <input type="checkbox"/> other				

15. Total disturbed acreage and maximum depth of permit area: (Include all acreage to be disturbed by mining and reclamation during the life of the mine. Total area to be disturbed: <u>10.10</u> acres. Area to be disturbed in next 36 months: <u>1</u> acres. Maximum vertical depth (thickness) mined below pre-mining topographic grade will be <u>60</u> feet. Lowest elevation of excavated mine will be <u>170</u> feet relative to mean sea level. Highest elevation of excavated mine will be <u>400</u> feet relative to mean sea level.	
16. Expected start date of mining: Existing	17. Estimated number of years: 40 years
18. Total quantity to be mined over life of mine (estimated): 400,000 <input type="checkbox"/> tons or <input checked="" type="checkbox"/> cu yds	19. Estimated annual production: 10,000 <input type="checkbox"/> tons or <input checked="" type="checkbox"/> cu yds
20. Subsequent land use: <input type="checkbox"/> industrial <input type="checkbox"/> commercial <input type="checkbox"/> residential <input type="checkbox"/> agricultural <input type="checkbox"/> forestry <input type="checkbox"/> wetlands and lakes <input checked="" type="checkbox"/> other Unknown – once mining ceases and the land has been reclaimed it will be sold and developed by the new owner. Reclaimed elevation of floor of mine: <u>170</u> feet relative to mean sea level Reclaimed elevation is shown on cross sections? <input checked="" type="checkbox"/> yes <input type="checkbox"/> no Subsequent land use is compatible with County or Municipal comprehensive plan? <input checked="" type="checkbox"/> yes <input type="checkbox"/> no County or Municipality Approval for Surface Mining (Form SM-6) attached? <input checked="" type="checkbox"/> yes <input type="checkbox"/> no SEPA Checklist required? <input checked="" type="checkbox"/> yes <input type="checkbox"/> no If any answers are no, explain:	
21. Application fee for a new reclamation permit is herewith attached? <input checked="" type="checkbox"/> yes <input type="checkbox"/> no	

RECEIVED
JAN 26 2016
Geology and Earth Rscs

RECEIVED
NOV 09 2015
Geology and Earth Rscs

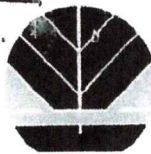

**APPLICATION FOR
RECLAMATION PERMIT
(Form SM-8A)**

Check appropriate box(es): new permit revision of existing permit transfer of permit expansion

NOTE: Do not attempt to complete this form until you have carefully read "Instructions for Form SM-8A".

1. NAME OF APPLICANT/PERMIT HOLDER(S) Egg Lake Quarry LLC C/O Myron Williams				
2. MAILING ADDRESS 65 Gill Lane, Friday Harbor, WA 98250-9614				
3. Telephone (360) 378-2288 UBI No. 602-152-803				
4. NAME OF MINE Egg Lake Quarry				
5. Street address and milepost of surface mine The mine is located at 65 Gill Lane (0.6 milepost on Egg Lake Road).				
6. Distance (miles)	7. Direction from Northeast	8. Nearest community Friday Harbor		
9. COUNTY San Juan No attachments will be accepted. Legal Description of permit area:				
1/4	1/4	Section	Township	Range
	SE	32	36N	3W
10. TOTAL ACREAGE OF PERMIT AREA APPLIED FOR: (Include all acreage to be permitted. See Form SM-6.) 10.10 acres				
11. Do you or any person, partnership, or corporation associated with you now hold, or have you held, a surface mining operating or reclamation permit? <input type="checkbox"/> yes <input checked="" type="checkbox"/> no If you answered yes to the above, please list:				
Permit Number	Active Operation?		Reclamation current/complete?	
	Yes	No	Yes	No
	<input type="checkbox"/>	<input type="checkbox"/>	<input type="checkbox"/>	<input type="checkbox"/>
	<input type="checkbox"/>	<input type="checkbox"/>	<input type="checkbox"/>	<input type="checkbox"/>
	<input type="checkbox"/>	<input type="checkbox"/>	<input type="checkbox"/>	<input type="checkbox"/>
	<input type="checkbox"/>	<input type="checkbox"/>	<input type="checkbox"/>	<input type="checkbox"/>
12. Are all of these mines now in compliance with RCW 78.44, WAC 332-18, and conditions of the permits? <input type="checkbox"/> yes <input type="checkbox"/> no				
13. Have you ever had a surface mine operating or reclamation permit revoked? <input type="checkbox"/> yes <input checked="" type="checkbox"/> no Have you ever had a reclamation security forfeited? <input type="checkbox"/> yes <input checked="" type="checkbox"/> no If you answered yes to either of the above, give permit number(s):				
14. Type of proposed or existing mine: <input type="checkbox"/> pit <input checked="" type="checkbox"/> quarry Material(s) to be mined: <input type="checkbox"/> sand and gravel <input checked="" type="checkbox"/> rock or stone <input type="checkbox"/> clay <input type="checkbox"/> metal <input type="checkbox"/> limestone <input type="checkbox"/> silica <input type="checkbox"/> other Deposit type: <input checked="" type="checkbox"/> glacial <input type="checkbox"/> river floodplain (alluvial) <input type="checkbox"/> river channel deposits <input type="checkbox"/> talus <input checked="" type="checkbox"/> bedrock <input type="checkbox"/> lode <input type="checkbox"/> unknown <input type="checkbox"/> other				

15. Total disturbed acreage and maximum depth of permit area:
(Include all acreage to be disturbed by mining and reclamation during the life of the mine.
Total area to be disturbed: **10.10** acres.
Area to be disturbed in next 36 months: **1** acres.
Maximum vertical depth (thickness) mined below pre-mining topographic grade will be **60** feet.
Lowest elevation of excavated mine will be **170** feet relative to mean sea level.
Highest elevation of excavated mine will be **400** feet relative to mean sea level.

16. Expected start date of mining: Existing	17. Estimated number of years: 40 years
18. Total quantity to be mined over life of mine (estimated): 800,000 <input type="checkbox"/> tons or <input checked="" type="checkbox"/> cu yds	19. Estimated annual production: 20,000 <input type="checkbox"/> tons or <input checked="" type="checkbox"/> cu yds

20. Subsequent land use: industrial commercial residential
 agricultural forestry wetlands and lakes
 other **Unknown – once mining ceases and the land has been reclaimed it will be sold and developed by the new owner.**
Reclaimed elevation of floor of mine: **170** feet relative to mean sea level
Reclaimed elevation is shown on cross sections? yes no
Subsequent land use is compatible with County or Municipal comprehensive plan? yes no
County or Municipality Approval for Surface Mining (Form SM-6) attached? yes no
SEPA Checklist required? yes no
If any answers are no, explain:

21. Application fee for a new reclamation permit is herewith attached? yes no

RECEIVED
JAN 26 2016
Geology and Earth Resources

RECEIVED
NOV 05 2015
Geology and Earth Resources

APPLICATION FOR RECLAMATION PERMIT

22. SEGMENTAL RECLAMATION

Permit area has been divided into segments for mining and a mining schedule has been developed? yes no
 If no, explain: **The quarry is small with just one mine area.**

Permit area has been divided into segments for reclamation and a reclamation schedule has been developed? yes no
 If no, explain: **Reclamation will occur in small areas.**

23. SITE PREPARATION

23A. Permit and Disturbed Area Boundaries

Boundary of the permit area has been marked on the ground with permanent boundary markers? yes no
 Explain boundary markers: **The site has been surveyed.**

23B. Saving Topsoil, Subsoil, and Overburden for Reclamation

Thickness of topsoil is 0 feet Thickness of subsoil is 0 feet Depth to bedrock is 0 feet
 Total volume of topsoil is 0 cubic yards Total volume of subsoil is 0 cubic yards
 Volume of stored topsoil/subsoil is 0 cubic yards and will require 0 acres for storage.

Storage areas are shown on maps and have been marked on the ground with permanent boundary markers? yes no

Topsoil will be salvaged? yes no
 If no, explain:

Topsoil and overburden will be moved to reclaim an adjacent depleted segment? yes no
 If no, explain:

Before materials are moved, vegetation will be cleared and drainage planned for soil storage areas? yes no
 If no, explain:

Soil storage areas will be stabilized with vegetation to prevent erosion if materials will be stored for more than one season? yes no
 If no, explain:

23C. Setbacks and Screens

The setback for this site will be 30 feet wide along the inside edge of the permit boundaries except on the southeast where the setback will be provided on adjacent property owned by Myron Williams.

Is a permanent, undisturbed buffer planned for this site? yes no
 If no, explain:

Setbacks are shown on maps and have been marked on the ground with permanent boundary markers? yes no
 If no, explain: **Setback easement to the S & W are off-site on adjacent lots**

Does this site have a backfilling plan that addresses the protection of adjacent property and how the final, stable slopes are to be achieved? yes no
 If no, explain: **Slopes will remain as they exist today.**

23D. Buffers to Protect Streams and Flood Plains

A stream buffer of at least 200 feet has been marked on the ground with permanent boundary markers? yes no
If yes, see "Additional Requirements for Mines in Flood Plains" in "Instructions for SM-8A".

A buffer of at least 200 feet from the 100-year flood plain has been marked on the ground with permanent boundary markers? yes no
 If no, explain: **No flood plain exists on or near this property.**

Copy of Shoreline Permit from local government or the Department of Ecology is attached? yes no

Hydraulic Project Approval from the Department of Fish and Wildlife is attached? yes no

23E. Conservation Buffers

Conservation buffers will be established for the following purpose(s): *(Check all that apply)*

- unstable slopes wildlife habitat water quality other

Describe the nature and configuration of the conservation buffer(s):

APPLICATION FOR RECLAMATION PERMIT

Conservation setbacks are shown on maps and have been marked on the ground with permanent boundary markers?	<input type="checkbox"/> yes <input checked="" type="checkbox"/> no
23F. Ground Water	
High water table depth is 140 feet <input checked="" type="checkbox"/> relative to mean sea level, <input type="checkbox"/> below original surface, or <input type="checkbox"/> unknown. Low water table depth is 165 feet <input checked="" type="checkbox"/> relative to mean sea level, <input type="checkbox"/> below original surface, or <input type="checkbox"/> unknown. Annual fluctuation of water table is from 140 feet on October to 164 feet on April . Direction of ground water flow: NA	
Are well logs attached?	<input type="checkbox"/> yes <input checked="" type="checkbox"/> no
Is the aquifer perched?	<input type="checkbox"/> yes <input checked="" type="checkbox"/> no
The shallowest aquifer is <input checked="" type="checkbox"/> confined <input type="checkbox"/> unconfined?	
The site will be mined: <input type="checkbox"/> wet <input checked="" type="checkbox"/> dry <input type="checkbox"/> both Describe mining method: Excavating bedrock in benches and in floor area.	
The site is in a: <input checked="" type="checkbox"/> critical aquifer recharge area <input type="checkbox"/> sole source aquifer <input type="checkbox"/> public water supply watershed <input type="checkbox"/> wellhead protection area <input type="checkbox"/> special protection area <input type="checkbox"/> designated aquifer protection area	
Ground water study attached?	<input type="checkbox"/> yes <input checked="" type="checkbox"/> no
<i>If yes, see "Additional Requirements for Mines in Hydrologically Sensitive Areas" in "Instructions for SM-8A". If no, explain: The property is not within a hydrologically sensitive area.</i>	
23G. Archeology	
Are archeological/cultural resource sites present?	<input type="checkbox"/> yes <input checked="" type="checkbox"/> no
If yes, describe how you will protect these resources: San Juan County has indicated that this property does not encompass cultural or historical resources.	
24. MINING PRACTICES TO FACILITATE RECLAMATION	
24A. Soil Replacement	
Topsoil will be saved?	<input checked="" type="checkbox"/> yes <input type="checkbox"/> no
If no, explain:	
Up to 4 feet of topsoil and (or) subsoil will be restored?	<input type="checkbox"/> yes <input checked="" type="checkbox"/> no
If "yes" give details. If "no", explain: There was never 4' of top soil existing on this site to be restored.	
Topsoil will be restored and seedbeds prepared as necessary to promote effective revegetation and to stabilize slopes and mine floor?	<input checked="" type="checkbox"/> yes <input type="checkbox"/> no
If "yes" give details. If "no", explain: Topsoil on this site will be reserved and supplemented with imported topsoil and 2" of compost that will be used on bench areas for revegetation with native grasses. The pit floor will not be revegetated.	
Subsoil will be replaced to an approximate depth of <u>0</u> feet on the pit floor and a depth of <u>0</u> feet on slopes. Topsoil will be replaced to an approximate depth of <u>0</u> feet on the pit floor and a depth of <u>0</u> feet on slopes.	
Topsoil will be distributed evenly over the site?	<input type="checkbox"/> yes <input checked="" type="checkbox"/> no
If no, explain: Topsoil will be placed on benches for revegetation purposes.	
If topsoil is in short supply, it will be strategically placed in depressions and low areas in adequate thickness to conserve moisture and promote revegetation?	<input type="checkbox"/> yes <input checked="" type="checkbox"/> no
If no, explain: The topsoil will be placed on the rocky benches to promote growth of native grasses.	
Topsoil will be moved when conditions are not overly wet or dry?	<input checked="" type="checkbox"/> yes <input type="checkbox"/> no
If no, explain:	
Topsoil will be imported?	<input checked="" type="checkbox"/> yes <input type="checkbox"/> no
If yes, describe source. The source of top soil will come from a local island property or imported from an off-island source. If no, explain:	

APPLICATION FOR RECLAMATION PERMIT

Synthetic topsoil made from compost, biosolids, or other amendments will be used and (or) made on site to supplement existing topsoil?	<input checked="" type="checkbox"/> yes <input type="checkbox"/> no
Materials such as till, loess, and (or) silt are available on site that could be used to supplement topsoil for reclamation. If yes, explain:	<input type="checkbox"/> yes <input checked="" type="checkbox"/> no
Silt from settling ponds or a filter press will be used for reclamation?	<input type="checkbox"/> yes <input checked="" type="checkbox"/> no
Settling pond clay slurries will be pumped or hauled to other segments for reclamation? If yes, explain:	<input type="checkbox"/> yes <input checked="" type="checkbox"/> no
Topsoil will be replaced with equipment that will minimize compaction, or it will be plowed, disked, or ripped following placement? If no, explain:	<input checked="" type="checkbox"/> yes <input type="checkbox"/> no
Topsoil will be immediately stabilized with grasses and legumes to prevent loss by erosion, slumping, or crusting? If no, explain:	<input checked="" type="checkbox"/> yes <input type="checkbox"/> no
Topsoil stockpile areas are shown on maps and will be marked on the ground with permanent boundary markers to protect from loss? If no, explain:	<input checked="" type="checkbox"/> yes <input type="checkbox"/> no
Segmental topsoil removal and replacement is shown on maps? If no, explain:	<input checked="" type="checkbox"/> yes <input type="checkbox"/> no
Topsoil salvage and replacement plan included? If no, explain:	<input checked="" type="checkbox"/> yes <input type="checkbox"/> no
24B. Removal of Vegetation	
Vegetation will be removed sequentially from areas to be mined to prevent unnecessary erosion? If no, explain:	<input checked="" type="checkbox"/> yes <input type="checkbox"/> no
Small trees and other transplantable vegetation will be salvaged for use in revegetating other segments? If yes, give details. If no, explain: The quarry is existing – there is little to no vegetation that could be salvaged and moved because the plant life is mature and would likely die.	<input type="checkbox"/> yes <input checked="" type="checkbox"/> no
Wood and other organic debris will be: <input checked="" type="checkbox"/> recycled <input type="checkbox"/> removed from site <input type="checkbox"/> chipped <input type="checkbox"/> burned <input type="checkbox"/> buried <input type="checkbox"/> used to synthesize topsoil or mulch <input type="checkbox"/> other (<i>explain</i>)	
Solid waste disposal, burning, and land use permits are attached?	<input type="checkbox"/> yes <input checked="" type="checkbox"/> no
Some coarse wood (logs, stumps) and other large debris will be salvaged for fish and wildlife habitats? If yes, give details. If no, explain: The required 30 foot buffer is fully vegetated with native mature growth forest which acts as habitat for wildlife. There are no streams on this property.	<input type="checkbox"/> yes <input checked="" type="checkbox"/> no
24C. Erosion control for Reclamation	
Pit floor will slope at gentle angles toward highwall, sediment retention pond, or proper drainage? If yes, give details. If no, explain: Pit floor will slope toward roadside ditches.	<input checked="" type="checkbox"/> yes <input type="checkbox"/> no
Revegetation, sheeting, and (or) matting will be used to protect areas susceptible to erosion? If yes, give details. If no, explain: There is very little soil on this property that is susceptible to erosion. However, topsoil and compost will be imported and placed on benches where native grasses will be planted to reduce erosion. The soil and seeds will be covered in organic mulch to prevent erosion until seed have sprouted and established a competent root system.	<input checked="" type="checkbox"/> yes <input type="checkbox"/> no

APPLICATION FOR RECLAMATION PERMIT

Water control systems used for erosion control during segmental reclamation will:	
Divert clean water around pit?	<input type="checkbox"/> yes <input checked="" type="checkbox"/> no
Trap sediment-laden runoff before it enters a stream?	<input type="checkbox"/> yes <input checked="" type="checkbox"/> no
Result in essentially natural conditions of volume, velocity, and turbidity?	<input checked="" type="checkbox"/> yes <input type="checkbox"/> no
Handle a 25-year, 24-hour peak event? <i>(Have you attached calculation?)</i>	<input checked="" type="checkbox"/> yes <input type="checkbox"/> no
Be removed or reclaimed?	<input type="checkbox"/> yes <input checked="" type="checkbox"/> no
If any answers are no, explain: The quarry remains dry year round. Rain from storm events is retained on site by earthen berms and naturally dissipates into the surrounding soils.	
Will any water control systems be removed upon final reclamation?	<input type="checkbox"/> yes <input checked="" type="checkbox"/> no
If yes, explain:	
Water control measure will be established to prevent erosion of setbacks and neighboring properties?	<input type="checkbox"/> yes <input checked="" type="checkbox"/> no
If yes, give details. If no, explain: The topography of the site is such that it slopes away from adjoining properties toward Egg Lake Road and Gill Lane. Setbacks consist of the required 30 foot vegetated buffer. This vegetative strip will act to trap sediments that are picked up by stormwater runoff and will provide area where stormwater can naturally dissipate on site.	
Storm-water conveyance ditches and channels will be lined with vegetation or riprap?	<input type="checkbox"/> yes <input checked="" type="checkbox"/> no
If yes, give details. If no, explain: There are no storm-water conveyance ditches or channels on site.	
Natural and other drainage channels will be kept free of equipment, wastes, stockpiles, and overburden?	<input checked="" type="checkbox"/> yes <input type="checkbox"/> no
If no, explain:	
25. RECLAMATION TOPOGRAPHY	
25A. Final Slopes	
Final slopes will be created using the cut-and-fill method?	<input type="checkbox"/> yes <input checked="" type="checkbox"/> no
Explain procedure to be used: Planned cut mining to get to final wall slope elevations with little fill.	
Slopes will be created by mining to the final slope using the cut method?	<input checked="" type="checkbox"/> yes <input type="checkbox"/> no
Explain procedure to be used: Excavate, shape and clean benches/berms to appropriate elevations with excavation equipment as mining occurs.	
Slopes will vary in steepness?	<input checked="" type="checkbox"/> yes <input type="checkbox"/> no
If no, explain:	
Slopes will have a sinuous appearance in both profile and plan view?	<input checked="" type="checkbox"/> yes <input type="checkbox"/> no
If no, explain:	
Large rectilinear (that is, right angle, or straight, planar) areas will be eliminated?	<input type="checkbox"/> yes <input checked="" type="checkbox"/> no
If no, explain: Some will remain on the highwall on the west side of the quarry	
Where reasonable, tracks of the final equipment pass will be preserved and oriented to trap moisture, soil, and seeds, and to inhibit erosion?	<input checked="" type="checkbox"/> yes <input type="checkbox"/> no
If no, explain:	
25B. Slope Requirements for Pits and Overburden/Waste Rock Dumps (non-saleable products)	
<i>If the mine is a quarry or in hard rock, skip to Quarry section (25C). This is a quarry</i>	
Slopes will vary between 2 and 3 feet horizontal to 1 foot vertical or flatter, except in limited areas where steeper slopes are necessary to create sinuous topography and control drainage?	<input type="checkbox"/> yes <input type="checkbox"/> no
If no, explain: NA – This is a quarry.	
For pits, slopes will not exceed 2 feet horizontal to 1 foot vertical except as necessary to blend with adjacent natural slopes?	<input type="checkbox"/> yes <input type="checkbox"/> no
Give details: NA	

APPLICATION FOR RECLAMATION PERMIT

Slope stability analysis required?	<input type="checkbox"/> yes <input type="checkbox"/> no
<i>If yes, see "Additional Requirements for Mines with Steep or Potentially Unstable Slopes" in "Instructions for SM-8A".</i>	
Slope stability analysis provided by NA .	
25C. Slope Requirements for Quarries and Hardrock Metal Mines	
<i>If mine is a pit in unconsolidated materials covered by Section 25B, go to Section 25D</i>	
Check the appropriate box(es)	
<input type="checkbox"/> Slopes will not exceed 2 feet horizontal to 1 foot vertical.	
<input type="checkbox"/> Slopes steeper than 1 foot horizontal to 1 foot vertical are an acceptable subsequent land use as confirmed on Form SM-6.	
<input checked="" type="checkbox"/> Hazardous slopes or cliffs are indigenous to the immediate area and already present a potential threat to human life. Photo and maps attached to document presence of cliffs.	
<input checked="" type="checkbox"/> Geologic or topographic characteristics of the site preclude slopes being reclaimed at a flatter angle and are an acceptable subsequent land use as confirmed on Form SM-6.	
Slope stability analysis required?	<input type="checkbox"/> yes <input checked="" type="checkbox"/> no
<i>If yes, see "Additional Requirements for Mines with Steep or Potentially Unstable Slopes" in "Instructions for SM-8A".</i>	
Slope stability analysis provided by	
Measures will be taken to limit access to the top and bottom of hazardous slopes?	<input checked="" type="checkbox"/> yes <input type="checkbox"/> no
Describe measures, or if no, explain: Berms and signage	
Selective blasting will be used to remove benches and walls and to create chutes, buttresses, spurs, scree slopes, and rough cliff faces that appear natural?	<input type="checkbox"/> yes <input checked="" type="checkbox"/> no
Describe procedures, or if no, explain: No blasting is required for mining this quarry.	
Reclamation blasting will be used to reduce the entire highwall to a screen or rubble slope less than 2 feet horizontal to 1 foot vertical?	<input type="checkbox"/> yes <input checked="" type="checkbox"/> no
Blasting plan is attached?	
If no, explain: No blasting is necessary to reclaim this site.	
Access to benches will be maintained for reclamation blasting?	<input type="checkbox"/> yes <input checked="" type="checkbox"/> no
If no, explain: There will be no reclamation blasting.	
Small portions of benches will be left to provide habitat for raptors and other cliff-dwelling birds?	<input checked="" type="checkbox"/> yes <input type="checkbox"/> no
25D. Backfilling	
Slopes will require backfilling?	<input type="checkbox"/> yes <input checked="" type="checkbox"/> no
Depth of backfilling is _____ feet.	
Slope stability compaction analysis required?	<input type="checkbox"/> yes <input checked="" type="checkbox"/> no
Compaction analysis provided by	
Backfilling plan and (or) permits are attached?	<input type="checkbox"/> yes <input checked="" type="checkbox"/> no
If no, explain: There will be no backfilling.	
Backfilling will be done with overburden material after topsoil has been separated?	<input type="checkbox"/> yes <input checked="" type="checkbox"/> no
If no, describe composition and source of backfill material: NA	
Explain method of placement of fill: NA	
Locations of stockpiles are shown on maps and will be marked on the ground with permanent boundary markers?	<input checked="" type="checkbox"/> yes <input type="checkbox"/> no
Will backfill be imported?	<input type="checkbox"/> yes <input checked="" type="checkbox"/> no
If yes, give volumes needed to meet reclamation plan:	
Areas to be backfilled are shown on maps?	<input type="checkbox"/> yes <input checked="" type="checkbox"/> no
If no, explain: There are no areas planned for backfill.	

APPLICATION FOR RECLAMATION PERMIT

All grading/backfilling will be done with clean, inert, non-organic solids? If yes, give details. If no, explain: NA	<input type="checkbox"/> yes <input checked="" type="checkbox"/> no
Backfilled slopes will be compacted? If yes, give details. If no, explain: NA	<input type="checkbox"/> yes <input checked="" type="checkbox"/> no
Will you be backfilling into water? If yes, is slope stability analysis attached? If yes, describe method:	<input type="checkbox"/> yes <input checked="" type="checkbox"/> no <input type="checkbox"/> yes <input checked="" type="checkbox"/> no
25E. Mine Floors	
Flat areas will be formed into gently rolling mounds? If yes, give details. If no, explain: Reclaimed floor will be gently sloped at about 3%.	<input checked="" type="checkbox"/> yes <input type="checkbox"/> no
Mine floor will be gently graded into sinuous drainage channels to preclude sheetwash erosion during intense precipitation? If yes, give details. If no, explain: No new drainage channels are proposed for reclamation.	<input type="checkbox"/> yes <input checked="" type="checkbox"/> no
Mine floor and other compacted areas will be bulldozed, plowed, ripped, or blasted to foster revegetation? If yes, give details. If no, explain: Dozed and ripped.	<input checked="" type="checkbox"/> yes <input type="checkbox"/> no
25F. Lakes, Ponds, and Wetlands	
Is water currently present in the area or will the mining penetrate the water table? If no, go to Section 25G.	<input type="checkbox"/> yes <input checked="" type="checkbox"/> no
Reclaimed areas below the permanent low water table in soil, sand, gravel, and other unconsolidated material will have a slope no steeper than 1.5 feet horizontal to 1 foot vertical? If yes, give details. If no, explain: No mining activity has or will occur below the water table.	<input type="checkbox"/> yes <input checked="" type="checkbox"/> no
If not already present, soils, silts, and clay-bearing material will be placed below water level to enhance revegetation? If yes, give details. If no, explain: No mining activity has or will occur below the water table.	<input type="checkbox"/> yes <input checked="" type="checkbox"/> no
Some parts of pond and lake banks will be shaped so that a person can escape from the water?	<input type="checkbox"/> yes <input checked="" type="checkbox"/> no
Armored spillways or other measures to prevent undesirable overflow or seepage will be provided to stabilize bodies of water and adjacent slopes? If yes, give details. If no, explain: There is no water on site.	<input type="checkbox"/> yes <input checked="" type="checkbox"/> no
Wildlife habitat will be developed, incorporating such measures as: Sinuous and irregular shorelines? Varied water depths? Shallow areas less than 18 inches deep? Islands and peninsulas? Give details:	<input type="checkbox"/> yes <input checked="" type="checkbox"/> no <input type="checkbox"/> yes <input checked="" type="checkbox"/> no <input type="checkbox"/> yes <input checked="" type="checkbox"/> no <input type="checkbox"/> yes <input checked="" type="checkbox"/> no
Ponds or basins will: Be located in stable areas? Have sufficient volume for expected runoff? Have an emergency overflow spillway? Spillways and outfalls will be protected (for example, rock armor) to prevent failure and erosion? If any answers are no, explain: The are no ponds or basins within the quarry boundaries.	<input type="checkbox"/> yes <input checked="" type="checkbox"/> no <input type="checkbox"/> yes <input checked="" type="checkbox"/> no <input type="checkbox"/> yes <input checked="" type="checkbox"/> no <input type="checkbox"/> yes <input checked="" type="checkbox"/> no
Proper measures will be taken to prevent seepage from water impoundments that could cause flooding outside the permitted area or adversely affect the stability of impoundment dams or adjacent slopes? If yes, give details. If no, explain: There are and will be no water impounds within the quarry boundaries.	<input type="checkbox"/> yes <input checked="" type="checkbox"/> no
Written approval from other agencies with jurisdiction to regulate impoundment of water is attached? If no, explain: There are and will be no water impounds within the quarry boundaries.	<input type="checkbox"/> yes <input checked="" type="checkbox"/> no

APPLICATION FOR RECLAMATION PERMIT

25G. FINAL DRAINAGE CONFIGURATION

Drainage will be capable of carrying the peak flow of the 25-year, 24-hour precipitation event?
(Data are available at DNR Region offices) yes no

If yes, are calculations attached? yes no

If yes, give details. If no, explain: **Stormwater run-off follows natural drainage patterns. Volume and velocity will remain unchanged.**

Drainages will be constructed on each reclaimed segment to control surface water, erosion, and siltation? yes no

Clean runoff is directed to a safe outlet? yes no

If either yes, give details. If no, explain: **Existing drainage controls consist of an earthen berm constructed around the mined areas which retains stormwater runoff on-site. Drainage controls that will be used during reclamation will includesilt fences and/or straw wattles when soils are exposed.**

Are these shown on maps? yes no

The grade of ditches and channels will be constructed to limit erosion and siltation? yes no

If yes, give details. If no, explain: **No storm-water drainage ditches or channels will be constructed.**

Natural-appearing drainage channels will be established upon reclamation? yes no

If yes, give details. If no, explain: **No storm-water drainage ditches or channels will be constructed.**

26. SITE CLEANUP AND PREPARATION FOR REVEGETATION

26A. Dealing with Hazardous Materials

Hazardous materials are present at the mine site? yes no

If no, go to Section 26B

The final ground surface drains away from any hazardous natural materials? yes no

If yes, give details. If no, explain: **NA**

Plan for handling hazardous mineral wastes indigenous to the site is attached? yes no

If no, written approval from all appropriate solid waste regulatory agencies attached? yes no

26B. Removal of Debris

All debris (garbage, 'bone piles', treated wood, old mining equipment, etc.) will be removed from the mine site? yes no
 yes no

All sheds, scale houses, and other structures will be removed from the site?

If either answer is yes, give details. If no, explain: **The existing shop will be retained and used for other purposes upon reclamation of the site.**

27. REVEGETATION

The mine site is in: eastern Washington western Washington
The mine site is: wet dry?

The average precipitation is **29 inches** per year.

Revegetation will start during the first proper growing season (fall for grasses and legumes, fall or late winter for trees and shrubs) following restoration of slopes? yes no

If yes, give details. If no, explain: **Top soil stockpiled during mining and top soil and compost imported into the site will be placed on benches followed by seeding with native grasses. The seeds will be covered with mulch until proper roots systems have developed. No trees or shrubs are planned for installation due to the need to irrigate and monitor them.**

Test plots will be used to determine optimum vegetation plans? yes no

The site will not be revegetated because:

- It is a rural area with a rainfall exceeding 30 inches annually and erosion will not be a problem (requires approval of DNR).
- Demonstration plots and areas will be used to show that active revegetation is not necessary.
- Revegetation is inappropriate for the approved subsequent use of this surface mine.

Explain: **Benches will be re-vegetated with compost and grasses**

Documentation is attached? yes no

APPLICATION FOR RECLAMATION PERMIT

27A. Recommended Pioneer Species

In the Sections below, check the species that will be planted at your mine site:

** indicates nitrogen-fixing species*

Western Washington Dry Areas

- | | | | |
|--|---|--|---|
| <input type="checkbox"/> alfalfa* | <input checked="" type="checkbox"/> lupine* | <input checked="" type="checkbox"/> clover* | <input type="checkbox"/> orchard grass |
| <input type="checkbox"/> cereal rye | <input type="checkbox"/> perennial rye | <input type="checkbox"/> colonial bent grass | <input type="checkbox"/> ponderosa pine |
| <input type="checkbox"/> creeping red fescue | <input type="checkbox"/> red alder* | <input type="checkbox"/> Douglas fir | <input type="checkbox"/> shore pine |
| <input checked="" type="checkbox"/> ground cover | <input type="checkbox"/> shrubs | <input checked="" type="checkbox"/> other | |

Western Washington Wet Areas

- | | | | |
|--|--|--|---------------------------------|
| <input type="checkbox"/> birdsfoot trefoil | <input type="checkbox"/> sedges | <input type="checkbox"/> cedar | <input type="checkbox"/> tubers |
| <input type="checkbox"/> cottonwood | <input type="checkbox"/> wetland grasses | <input type="checkbox"/> creeping red fescue | <input type="checkbox"/> willow |
| <input type="checkbox"/> red alder* | <input type="checkbox"/> other | | |

Eastern Washington Dry Areas

- | | | | |
|---|---|-----------------------------------|---|
| <input type="checkbox"/> alder* | <input type="checkbox"/> grasses | <input type="checkbox"/> alfalfa* | <input type="checkbox"/> juniper |
| <input type="checkbox"/> black locust | <input type="checkbox"/> lodgepole pine | <input type="checkbox"/> clover | <input type="checkbox"/> lupine* |
| <input type="checkbox"/> deciduous trees | <input type="checkbox"/> ponderosa pine | <input type="checkbox"/> shrubs | <input type="checkbox"/> deep-rooted ground cover |
| <input type="checkbox"/> diverse evergreens | <input type="checkbox"/> other | | |

Eastern Washington Wet Areas

- | | | | |
|---------------------------------------|-------------------------------------|---------------------------------|---------------------------------|
| <input type="checkbox"/> alder* | <input type="checkbox"/> cottonwood | <input type="checkbox"/> poplar | <input type="checkbox"/> sedges |
| <input type="checkbox"/> serviceberry | <input type="checkbox"/> tubers | <input type="checkbox"/> willow | |
| <input type="checkbox"/> other | | | |

Give planting details (stems/acres of trees and shrubs, see [Forest Practices manual](#); lbs/acre of grass, legume, or forb mixture):

Compost and seeding – native volunteers will be encouraged.

Describe weed control plan:

Blackberry, scotch broom, horsetail are noxious and other undesirable plants that will be removed.

27B. Planting Techniques

Revegetation at this site will require:

- | | | |
|--|---|--|
| Ripping and tilling? | <input checked="" type="checkbox"/> yes | <input type="checkbox"/> no |
| Blasting to create permeability? | <input type="checkbox"/> yes | <input checked="" type="checkbox"/> no |
| Mulching? | <input checked="" type="checkbox"/> yes | <input type="checkbox"/> no |
| Irrigation? | <input type="checkbox"/> yes | <input checked="" type="checkbox"/> no |
| Fertilization? | <input type="checkbox"/> yes | <input checked="" type="checkbox"/> no |
| Importation of clay- or humus-bearing soils? | <input checked="" type="checkbox"/> yes | <input type="checkbox"/> no |
| Other soil conditioners or amendments? | <input type="checkbox"/> yes | <input checked="" type="checkbox"/> no |

Give details: **Native and imported topsoil will be mixed with organic compost and placed on benches and the pit floor and then seeded with native grasses. Seeding will occur in the spring to take advantage of rainfall for irrigation.**

Trees and shrubs will be planted in topsoil or in subsoil amended with generous amounts of organic matter? yes no

If yes, give details. If no, explain: **No trees or shrubs will be planted. They will be left to naturally re-establish on site.**

Mulch will be piled around the base of trees and shrubs? yes no

High quality stock will be used? yes no

Trees and shrubs will be planted while they are dormant? yes no

Stock will be properly handled, kept cool and moist, and planted as soon as possible? yes no

Seeds will be covered with topsoil or mulch no deeper than one-half inch? yes no

If any answers are no, explain: **Trees and shrubs will not be planted as part of the reclamation plan.**

APPLICATION FOR RECLAMATION PERMIT

28. FINAL CHECKLIST

All required maps are attached? (<i>See "Instructions for SM-8A" for detailed requirements.</i>)	<input checked="" type="checkbox"/> yes	<input type="checkbox"/> no
All required cross sections are attached? (<i>See "Instructions for SM-8A" for detailed requirements.</i>)	<input checked="" type="checkbox"/> yes	<input type="checkbox"/> no
Geologic map attached (if required)? (<i>See "Instructions for SM-8A" for detailed requirements.</i>)	<input checked="" type="checkbox"/> yes	<input type="checkbox"/> no
All documents submitted have the date, the name and address of the permit holder, and the application number on every page of the material?	<input checked="" type="checkbox"/> yes	<input type="checkbox"/> no
The plan contains predominantly relevant information?	<input checked="" type="checkbox"/> yes	<input type="checkbox"/> no
Have you completed the SM-6 and has it been signed by the local jurisdiction?	<input checked="" type="checkbox"/> yes	<input type="checkbox"/> no
Have you provided the SEPA checklist?	<input checked="" type="checkbox"/> yes	<input type="checkbox"/> no
Have you provided a copy of the SEPA determination (DNS, MDNS, or DS)?	<input type="checkbox"/> yes	<input checked="" type="checkbox"/> no
Have you attached photographs?	<input checked="" type="checkbox"/> yes	<input type="checkbox"/> no
Are additional supplemental studies included?	<input type="checkbox"/> yes	<input checked="" type="checkbox"/> no
If yes, check the appropriate box(es) below:		
<input type="checkbox"/> Archeological	<input type="checkbox"/> Geohydrologic	<input type="checkbox"/> Backfill
<input type="checkbox"/> Topsoil	<input type="checkbox"/> Flood plain	<input type="checkbox"/> Conservational
<input type="checkbox"/> Other		<input type="checkbox"/> Slope stability
		<input type="checkbox"/> Vegetation
Other permits required? <input type="checkbox"/> yes <input checked="" type="checkbox"/> no		
If yes, check the appropriate box(es) below:		
<input type="checkbox"/> Shoreline Permit	<input type="checkbox"/> Water Discharge Permit	<input type="checkbox"/> Solid Waste Permit
<input type="checkbox"/> Air Quality Permit	<input type="checkbox"/> NPDS or General Discharge Permit	<input type="checkbox"/> Hydraulic Project Approval
<input type="checkbox"/> Special or Conditional Use Permit	<input type="checkbox"/> Other	

APPLICATION FOR RECLAMATION PERMIT

When signed by the applicant and approved by the Department of Natural Resources, this document and the associated maps, cross sections, reclamation narrative, and other attachments will be the approved reclamation plan for this permit that the permit holder must follow. Significant variations from the approved reclamation plan may require that a new plan be submitted to the Department for approval.

The applicant shall be considered as the permit holder for this surface mine and shall be responsible for compliance with Chapter 78.44 RCW, Chapter 332-18 WAC, the approved reclamation plan and attachments, and the conditions of the permit if issued by the Department of Natural Resources.

I hereby agree to comply with this plan. <i>Signature of applicant or company representative</i> 	Name and Title of Company Representative <i>(Please print)</i> Myron Williams Owner, president	Date signed 11-3-15
---	---	------------------------

SURFACE OWNERSHIP Give names, addresses, and signatures of all individuals with possessory interest in land. <i>(Attach signed copies of this page if more than one.)</i> Myron Williams, Egglake Quarry LLC I verify that the applicant has my permission to mine from my land. <i>Signature of landowner(s)</i> <i>Date signed</i> 1-18-16 I hereby verify that I have seen and approved this plan. <i>Signature of landowner(s)</i> <i>Date signed</i> 1-18-16	OWNERSHIP OF RIGHTS TO REMOVE MINERALS BY SURFACE MINING Give names, addresses, and signatures of all individuals with rights. <i>(Attach signed copies of this page if more than one.)</i> Myron Williams, Egglake Quarry LLC I verify that the applicant has my permission to mine this land. <i>Signature of rights owner(s)</i> <i>Date signed</i> 1-18-16 I hereby verify that I have seen and approved this plan. <i>Signature of rights owner(s)</i> <i>Date signed</i> 1-18-16
--	---

FOR DEPARTMENTAL USE ONLY

Date accepted	Accepted by:	Title:	Reclamation Permit No.
5-27-16	Cassie Gellum	Reclamation Inspector	13228

Comments by Department:

RECEIVED

JAN 26 2016

Geology and Earth Rscs



**SURFACE MINING
RECLAMATION
PERMIT
(Form SM-9)**

new expansion revision name change transfer

Permit Holder: EGG LAKE QUARRY LLC
Mailing Address: 65 GILL LN
FRIDAY HARBOR, WA 98250-9614

Pursuant to RCW 78.44, a Reclamation Permit hereby granted to the above-named permit holder to engage in surface mining on the property described in the application and material on file under this permit. The total area to be disturbed by surface mining, including the deposition of surface-mining refuse, shall be in accordance with the reclamation plan filed with and approved the by the Department of Natural Resources under this permit, and in accordance with the conditions and descriptions set forth in Exhibit "A" attached hereto and made a part hereof, and RCW 78.44.

TERM OF PERMIT

This permit shall be in effect from the date of issuance and shall remain in effect so long thereafter as the permit holder pays the annual basic fee for each site, complies with the Surface Mining Act and the rules promulgated thereunder, complies with the reclamation plan, and maintains a performance security as required by the Act.

CHANGE OR MODIFICATION OF RECLAMATION PLAN

The permit holder shall obtain written approval from the Department prior to any change or departure from the approved reclamation plan.

PERFORMANCE SECURITY

A performance security shall be submitted to and approved by the Department prior to commencement of surface mining. The permit holder may submit a cash deposit, assignment of a savings account or certificate of deposit, bank letter of credit, negotiable securities, or a corporate surety bond in the amount specified. The amount of the performance security shall be subject to adjustment according to RCW 78.44.

TRANSFER OF PERMIT

The transfer of this permit to another permit holder shall not be made unless approved in writing by the Department. A transfer shall not be approved unless the successor permit holder assumes all duties of the former permit holder to complete the reclamation of the land and the Department approves the successor permit holder's performance security.

PENALTIES

The Department may suspend surface mining or impose civil penalties if the permit holder conducts surface mining in any manner not authorized by RCW 78.44, the rules adopted thereunder, the approved reclamation plan, or this permit.

Permitted issued on May 27, 2016 . Permit revised on _____

Signature	<u>Carrie Gillum</u>	<u>SE</u>	<u>1/4, S</u>	<u>32</u>	T	<u>36</u>	N, R	<u>03 W</u>	WM
Name	<u>Carrie Gillum, LG</u>		<u>1/4, S</u>		T		N, R		WM
Title	<u>Reclamation Geologist</u>		<u>1/4, S</u>		T		N, R		WM
Division of	<u>Geology & Earth Resources</u>		<u>1/4, S</u>		T		N, R		WM

TOTAL ACREAGE AND DEPTH OF PERMIT AREA

(Include all acreage to be disturbed by mining, setbacks, buffers, and associated activities during the life of the mine. See SM-8A)

Total permit acreage 10.10

Maximum vertical depth below pre-mining topographic grade is 60 feet

Maximum depth of excavated mine floor is 170 feet relative to mean sea level

DNR Surface Mining Reclamation
Permit No.
70-013228

EXHIBIT A
Conditions of the Permit

Surface Mining Reclamation Permit # 70-013228

May 27, 2016

1. This surface mining reclamation permit applies to the following permit area: a 10.10-acre permitted area in a portion of the SE quarter of Section 32, Township 36 North, Range 03 West, Willamette Meridian, San Juan County.
2. All mining and reclamation shall comply with the rules and regulations pursuant to Chapter 78.44 RCW and Chapter 332-18 WAC.
3. All mining and reclamation shall comply with the reclamation plan dated November 3, 2015 by the permittee, and approved by the Department of Natural Resources on May 27, 2016. Any amendment or change to the plan must be submitted to and approved in writing by the Department. The Reclamation Plan consists of the following documents:
 - Permit Letter, dated May 27, 2016
 - Surface Mining Reclamation Permit (Form SM-9) dated May 27, 2016
 - Exhibit A, listing **13** conditions of the permit
 - Standard Reclamation Plan
 - Application for Reclamation Permit (Form SM-8A) dated by the permittee on November 3, 2015, date stamped received by Geology and Earth on January 26, 2016.
 - County or Municipality Approval for Surface Mining (Form SM-6) dated by the permittee on April 20, 2015, and approved by San Juan County Planning on April 20, 2015, date stamped received by Geology and Earth on November 9, 2015.
 - Reclamation Narrative, date stamped received by Geology and Earth on November 9, 2015.
 - Reclamation Plan Maps: Sheets 1 of 2 and page 2, each date stamped received by Geology and Earth on November 9, 2015.
4. If there is any conflict between the conditions in Exhibit A and any other language of the approved reclamation permit (which includes the reclamation plan, maps, and supporting documents), the language in Exhibit A will prevail.
5. The permit holder shall mark the perimeter of the 10.10-acre permitted area with highly visible permanent markers and vegetation as described in the Reclamation narrative. The markers will be used to delineate the permit boundary enabling the operator, permittee, and the Department of Natural Resources (DNR) to monitor the progress of mining and reclamation. Permanent boundary markers shall be visible such that the entire perimeter of the site could be reestablished using the GPS, if any marker was destroyed.

6. The permitted depth at this site is 60 vertical feet from the original ground surface. No excavation shall occur below an elevation of 170 feet mean sea level (msl). If additional mining depth is anticipated the reclamation plan shall be revised prior to exceeding the permitted depth.
7. Reclaimed slopes will not exceed 0.5 ft. horizontal and 1 ft. vertical slope. Steep slopes are indigenous to the area; final reclaimed slopes shall mimic surrounding natural topography to the extent possible, are stable and shall have a sinuous appearance in both plan and profile views as shown on map sheet 1 of 2 and page 2.
8. A minimum 30-foot permanent setback shall be maintained interior to the Permit Boundary as shown on Map Sheet 1 of 2.
9. Topsoil shall be stockpiled within the permit area of the mine as shown on map sheet 1 of 2. Stockpiles shall be seeded with grasses during storage and incorporate other Best Management Practices (BMPs) for erosion control as needed. Topsoil shall not be buried, removed or sold as a product from the permit area.
10. Revegetation shall be completed as detailed in the narrative and Form SM-8a. Natural revegetation only shall not be deemed satisfactory. Prior to any variation from the revegetation plan, written approval must be obtained from the Department.
11. Reclaimed slopes shall be created using the "mine to grade" method of mining. No backfill shall be used to create reclaimed slopes. Importation of backfill for use in reclamation is not permitted for this site.
12. The site is to be mined dry. If groundwater is encountered, mining must cease immediately in the area. The permit holder will contact DNR to schedule a meeting to determine further actions. A revision to the permit may be required.
13. The permit holder or operator shall maintain a complete copy of this permit, including these conditions and the approved reclamation plan with additions and amendments, at the mine site during all mining and reclamation activities.